

Bluetooth Body Fat Analyzer BFTS01

Description:

Smart body fat scale is specially designed to test your body weight, body fat, hydration, muscle and bone percentages and to help you keep a close eye on the daily changes of your body fat, hydration, muscle, bone and weight. Based on the analysis of your height, weight, age, etc., it calculates your daily energy requirement, and can be used as a helpful tool to control your weight.

Main Feature



LED/LCD display, Full ABS base with ITO coating.

BLE 4.0 body fat scale, connects with Android and IOS system

- 1.Generate and display curves of your weight,body fat, hydration, muscle mass, bone mass, calorie on your portable devices through APP, sync and save data to server automatically.
- 2.With internal memory to store over 8 users and can be sent next time to your phone, no need to use the APP all the time.
- 3.Once BT is in range, all the data will be dumped. Evaluate and grade physical condition, display all data in reports.
- 4.Ability to set and track your goal with historic trend. Know every family member's health index in one App.
- 5.Step-on Technology-Get instant readings with no tapping to turn on.
- 6.Support IOS&Android system.
- 7.Share you exercise achievement onto blog, twitter, facebook.
- 8.High Tempered glass with unique stable feet, highly-precise weight sensor.Safe and stable design, anti-turn over and crash design.

Technical Parameters

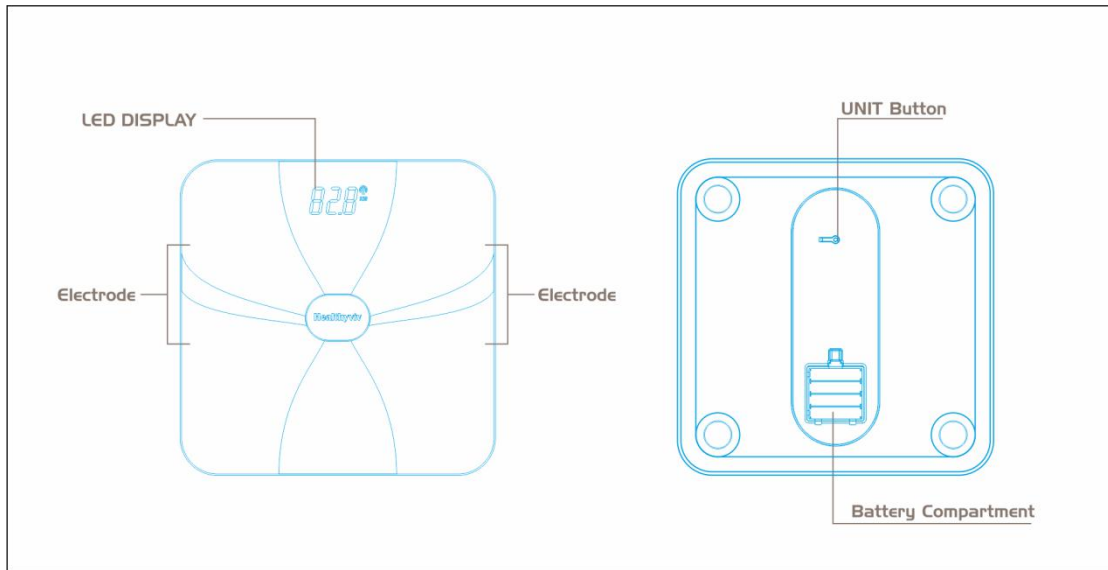

Max Capacity:	3~180KG/396lb	Units:	kg/lb/st
Graduation:	100g/0.2lb	Scale work:	Auto on/Auto off, Low battery and overload indication
Accuracy:	(2-100kg)+-0.4; (101-180KG): +-0.5	Battery:	4×AAA
LCD/LED size:	3.3inch/76.5x35mm with blue backlight	Measure:	Weight,BMI,Body fat,Body water,Protein,Bone mass,Muscle mass,Visceral fat,Subutaneous fat
Tempered glass:	6mm	Product Size:	300x300x27mm
Sensor:	With high precision strain gauge sensor	Package Size:	1PC / 345x345x58mm
Packing:	1PC / Color BOX or mailbox	Carton Dimension:	10PCS / CTN / /620x360x375mm
Gross weight:	10PCS / CTN / /20.95KG	Net weight:	10PCS / CTN / /18.0KG